

# PT1000

## Blood Gas Analyzer

### All-in-one Cartridge

- No fluidics in instrument, maintenance free
- Self-contained calibration, cleaning solution and biohazard waste collection pack
- Optimized cartridge design minimizes clot formation

### High Efficiency

- Revolutionary microsensors technology, 33 parameters in only 60 seconds
- Automatic calibration and continuous system performance monitoring
- Built-in printer, print results automatically after detection

### Easy Operation

- Touch-screen with intuitive prompts
- Simple 4-step process, easy to use
- Supports HL7 protocol for LIS/HIS

### Ultimate Flexibility

- Compact size for various units (ICU, ED, OR, etc.)
- Convenient handle, easy to carry
- Built-in battery, 4 hours back-up



## Instrument Specification

Category	Specification
Throughput	Results in 60 Seconds after Sample Aspiration
Sample Volume	150µL
Operation Environment	10°C-31°C
Power Supply	AC 100 ~ 240V, 50Hz/60Hz
Dimensions & Net Weight	260*270*410mm, 9.5Kg
Display	10.4-inch color LCD touch screen display, resolution 1024*768
Battery	Lithium-ion battery 14.8v/6500mAh
Accessory	Barcode scanner
Interface	4*USB 2.0 host, WLAN
Storage Capacity	100000+ Tests
Communication Link	Supports HL7 protocol for LIS/HIS

## Test Menu

Measurement Parameters (10 items)			
Parameter	Unit	Reportable Range	Precision (CV)
pH	-	6.8-8.0	SD≤0.02
pO <sub>2</sub>	mmHg	20-600	CV≤7.5%
pCO <sub>2</sub>	mmHg	15-130	SD≤2.5mmHg
Na <sup>+</sup>	mmol/L	100-180	CV≤1.5%
K <sup>+</sup>	mmol/L	2.0-9.0	SD≤0.25mmol/L
Ca <sup>++</sup>	mmol/L	0.25-2.5	SD≤0.15mmol/L
Cl <sup>-</sup>	mmol/L	70-150	CV≤5%
Glu	mmol/L	1.1-27	CV≤5%
Lac	mmol/L	0.3-17	CV≤7.5%
Hct	%PCV	20%-70%	CV≤3%

Calculation Parameters (23 items)			
cH <sup>+</sup> , cH <sup>+</sup> (T), pH(T), pCO <sub>2</sub> (T), pO <sub>2</sub> (T), HCO <sub>3</sub> -act, HCO <sub>3</sub> -std, BB(B), BE(B), BE(ecf), CtCO <sub>2</sub> , Ca <sup>++</sup> (7.4), sO <sub>2</sub> (est), AnGap, tHb(est), pO <sub>2</sub> (A-a), pO <sub>2</sub> (A-a) (T), pO <sub>2</sub> (a/A), pO <sub>2</sub> (a/A) (T), RI, RI(T), pO <sub>2</sub> /FIO <sub>2</sub> , pO <sub>2</sub> (T)/FIO <sub>2</sub>			

## Cartridge Specification

Category	Model	Analyze Items	Spec.
Cartridges	PT3	pH, pCO <sub>2</sub> , pO <sub>2</sub>	60 tests/kit
	PT4L	pH, pCO <sub>2</sub> , pO <sub>2</sub> , Lac	
	PT4H	pH, pCO <sub>2</sub> , pO <sub>2</sub> , Hct	
	PT5	pH, pCO <sub>2</sub> , pO <sub>2</sub> , Lac, Hct	120 tests/kit
	PT6E	pH, Na <sup>+</sup> , K <sup>+</sup> , Ca <sup>++</sup> , Cl <sup>-</sup> , Hct	
	PT6	pH, pCO <sub>2</sub> , pO <sub>2</sub> , Glu, Lac, Hct	200 tests/kit
	PT8	pH, pCO <sub>2</sub> , pO <sub>2</sub> , Na <sup>+</sup> , K <sup>+</sup> , Ca <sup>++</sup> , Cl <sup>-</sup> , Hct	
	PT9L	pH, pCO <sub>2</sub> , pO <sub>2</sub> , Na <sup>+</sup> , K <sup>+</sup> , Ca <sup>++</sup> , Cl <sup>-</sup> , Lac, Hct	300 tests/kit
	PT9G	pH, pCO <sub>2</sub> , pO <sub>2</sub> , Na <sup>+</sup> , K <sup>+</sup> , Ca <sup>++</sup> , Cl <sup>-</sup> , Glu, Hct	
	PT10	pH, pCO <sub>2</sub> , pO <sub>2</sub> , Na <sup>+</sup> , K <sup>+</sup> , Ca <sup>++</sup> , Cl <sup>-</sup> , Glu, Lac, Hct	
Storage Temperature	15°C~25°C		
Shelf Life	180 days		
Onboard Shelf Life	21 days		
Sample Type	Arterial blood, venous blood, capillary blood, quality control		
Dimensions	194*92*207mm		
Weight	2kg		
Calibration	One point calibration, two point calibration		
Components	Calibration solution, rinse solution, sensors, sample probe and waste bag		

## Operation



1. Choose items and click "Start" to take the test.

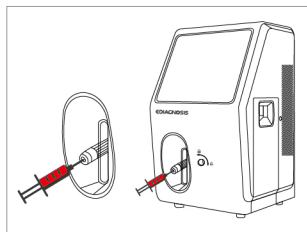

2. Auto aspirate the sample to be tested.

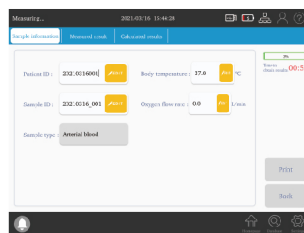

3. Scan or enter patient ID.



4. Wait for 60s and print test results.

Wuhan EasyDiagnosis Biomedicine Co., Ltd.

Web: [www.easydiagnosis.com](http://www.easydiagnosis.com)

Email: [info@easydiagnosis.com](mailto:info@easydiagnosis.com)

Tel: 0086-27-65523649, 0086-27-65524011

Add: Bldg 25, Phase 3.1, Wuhan Optics Valley International Biopharmaceutical Enterprise Park, No. 388, Gaoxin 2nd Rd East Lake Hi-Tech Development Zone 430074, Wuhan, Hubei, China

